

Trade only supplier of CNC Inframe products & Overlay doors for complete kitchen and bedroom solutions.

- ◆ **Fast order fulfilment**
- ◆ **Competitive price point**
- ◆ **Precision Guaranteed**



SCF-inframe is designed to provide installers and makers the opportunity to offer high end inframe products with a fast order turnaround and at a competitive price point.

- ◆ Five door styles [all with choice of either Flat Panel or Raised & Fielded Panel]
- ◆ Three frame styles - Beaded, Square or Chamfer.
- ◆ Accessory items: Plinth, Cornice, End Panels, Mantels etc
- ◆ Capability to offer both 'Concealed' style hinges and also Butt Hinges. Our unique manufacturing process ensures that butt hinge fixings are of equal strength to those in solid wood construction.

Project Example

Square edge doors
with flat panels
in square frame

Finished with F&B
Purbeck Stone



WHAT IS SCF-INFRAME?

SCF-Inframe or Overlay doors and drawer fronts are CNC machined from a single sheet of 22mm thickness Hidrofugo MDF. Thereby creating an extremely stable and durable product, and eliminating future possibility of movement and open joints.

Hidrofugo is the industry-standard moisture-resistant MDF board that complies with EN 321 and V313 specifications for high-humidity applications. This board is the go-to choice for construction professionals and specifiers seeking reliable, high-performance materials for demanding environments.

THE PROCESS:

- ◆ **Select a door style**
- ◆ **Select a frame style**
- ◆ **Select a cabinet layout**
- ◆ **Select cornice, plinth**
- ◆ **Select other accessories i.e. End Panels etc**
- ◆ **Send a rough sketch and dimensions.**

We will then return a quotation to you.

Including the inframe door and drawer, end panels, cornice, plinth, mantels and other accessory items.

- ◆ For an idea of cost, request our trade price guide showing the most commonly specified items.
- ◆ For a quotation, send us a rough sketch and dimensions and we will return a quote to you.
- ◆ Upon order payment, a comprehensive drawing pack for each component will be provided for sign off prior to commencement of production.
- ◆ An elevation drawing presentation is also available on request at an additional cost.

◆ **DOOR STYLES**

- ◆ Five door styles [all with choice of either flat panel or raised & fielded panel]
- ◆ Three frame styles - Beaded, Square or Chamfer.
- ◆ Accessory items: Plinth, Cornice, End Panels, Mantels etc

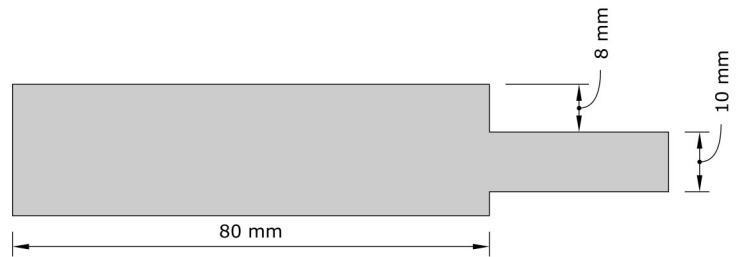
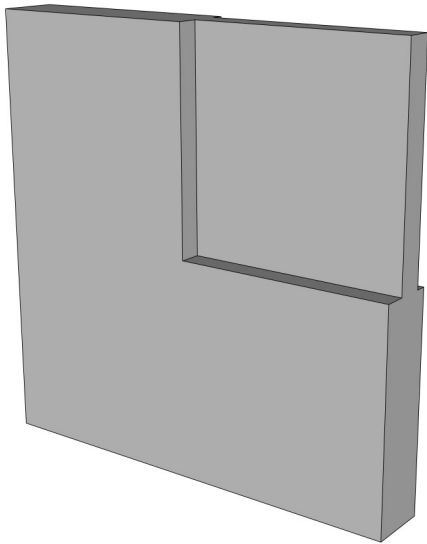

SQUARE EDGE

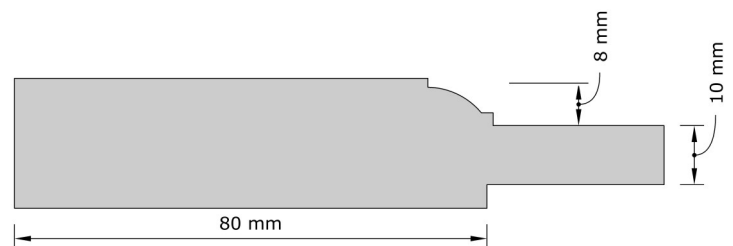
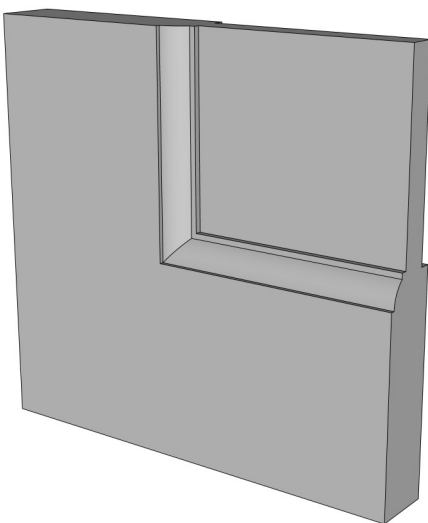

OVOLO

All door profiles are available with either Flat Panels or Raised & Fielded panels

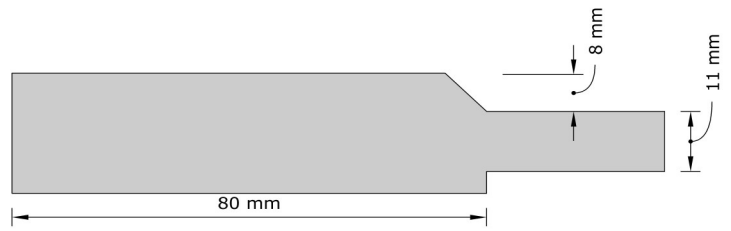
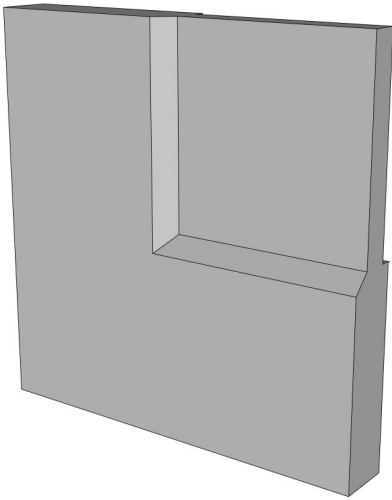

CHAMFER

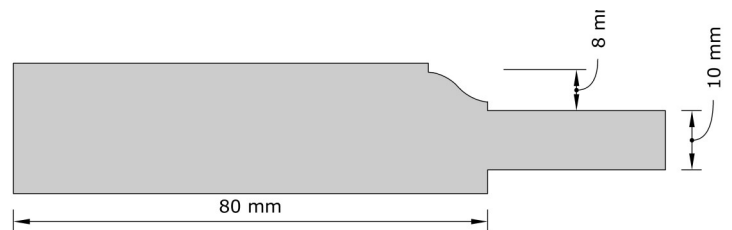
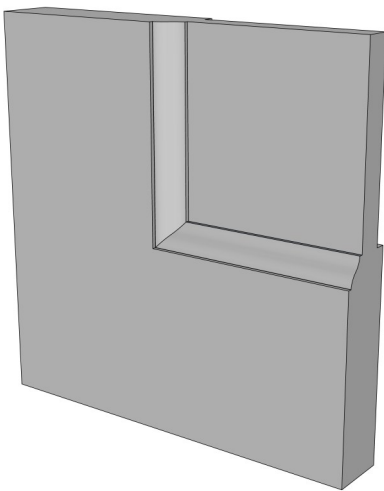

OGEE

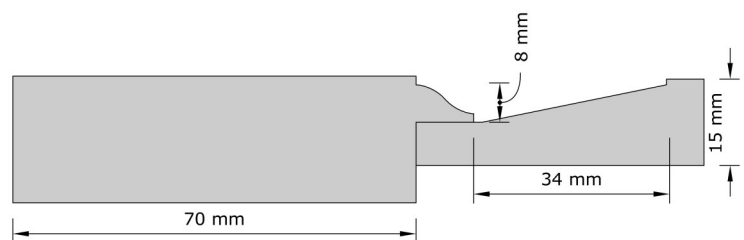
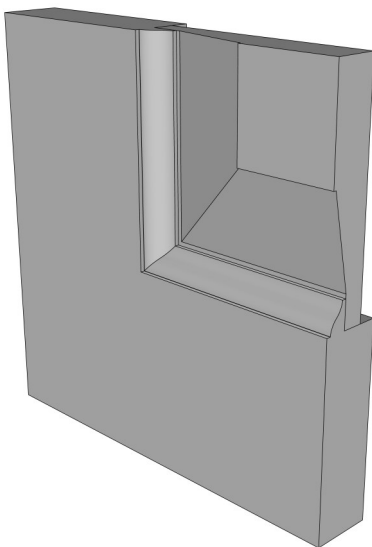

RAISED & FIELD

All door profiles are available with either Flat Panels or Raised & Fielded panels

FRAME OPTIONS

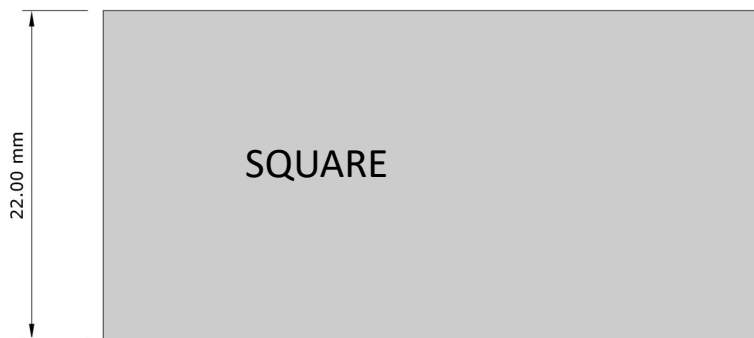
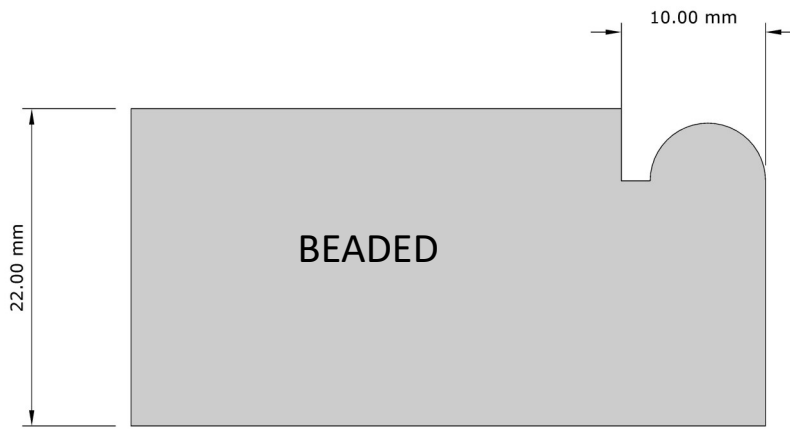

SUNDRY ITEMS

Range of items including Plinth, Cornice, Mantels, End Panels etc.

CORNICE

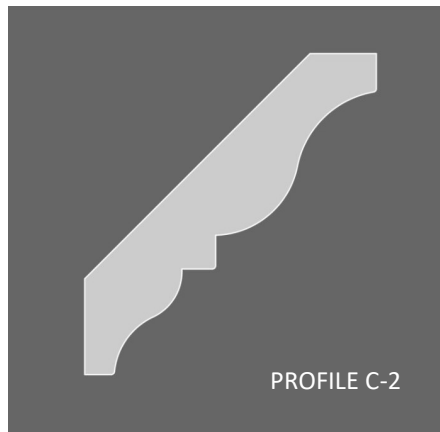

PLINTH

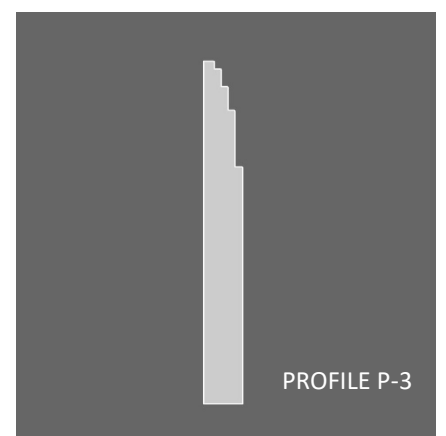
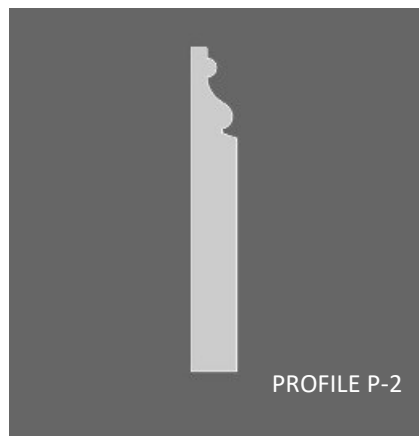

MANTELS [CUSTOMISED TO ORDER]

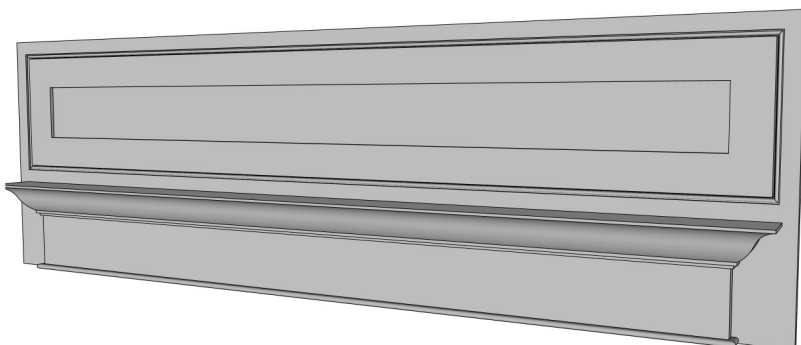

COMMON LAYOUT EXAMPLES

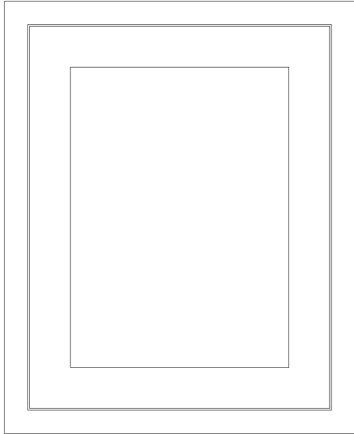

FULL DOOR

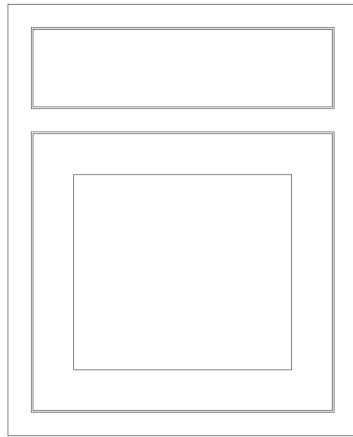

SINGLE DOOR + DRAWER

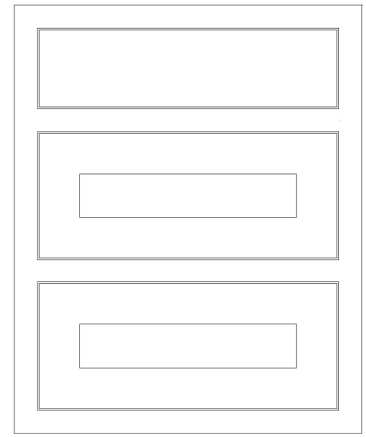

THREE DRAWER OFFSET

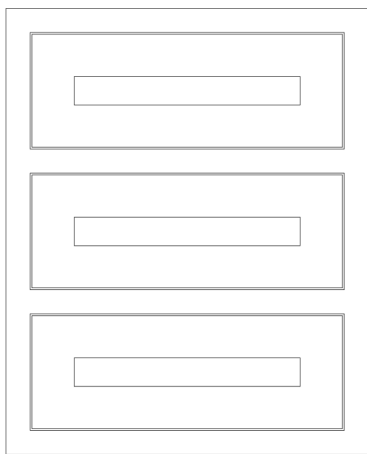

THREE DRAWER EQUAL

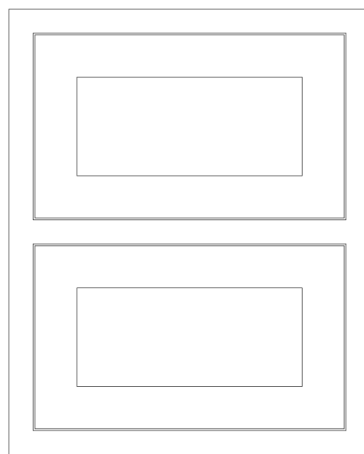

TWO DRAWER EQUAL

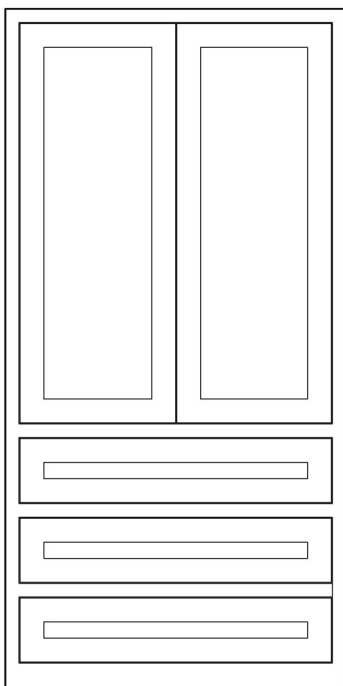

TALL DOOR AND DRAWER SPLIT

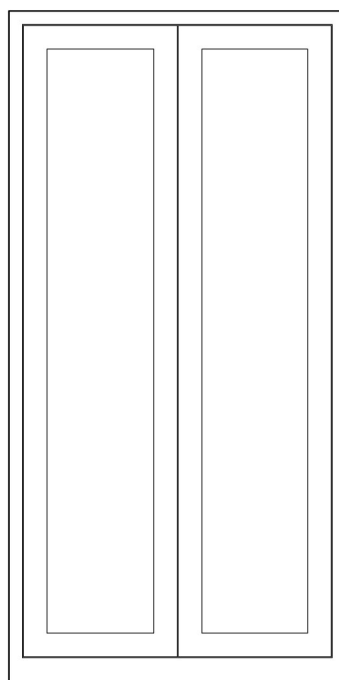

TALL DOOR DOUBLE

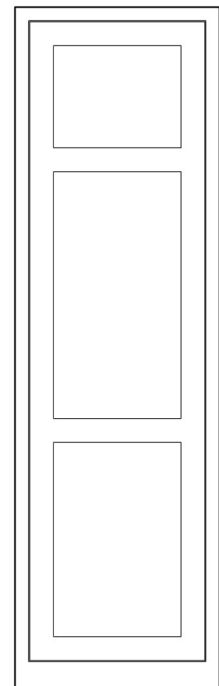

TALL DOOR SINGLE

Project Example

Ogee doors with flat panel and beaded frame

Finished with F&B Railings



The Benefits of SCF-Inframe products & Overlay Doors

- ◆ Products and costs are only available to the TRADE.
- ◆ Items are easy to take from raw MDF - to primed - to topcoat.
- ◆ Where our priming service is selected, products will arrive ready to topcoat.
- ◆ CNC cut for perfect margins, and doors pre hung.
- ◆ No joints = no movement or cracking of paint over time.
- ◆ Items are unbranded - giving you the opportunity to create your own branding.

Advantages through Processes saved for customer

- ◆ Outsourced production of doors and frames = time saved and profit maximised.
- ◆ No investment on machinery
- ◆ Free up of labour/man hours in production
- ◆ Increased diary capacity
- ◆ CNC precision, eliminating human error
- ◆ No storage of materials and no disposal of workshop waste

Minimal investment - Maximum profit !

Complementary Hardware

Soft Close Magnetic Catch (Exclusive to SCF Hardware)

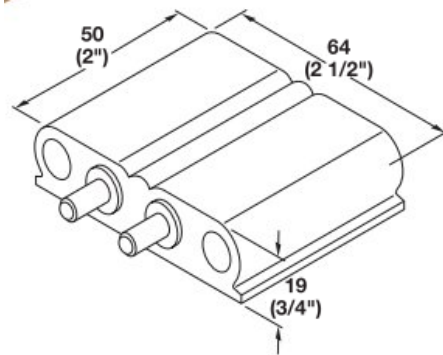
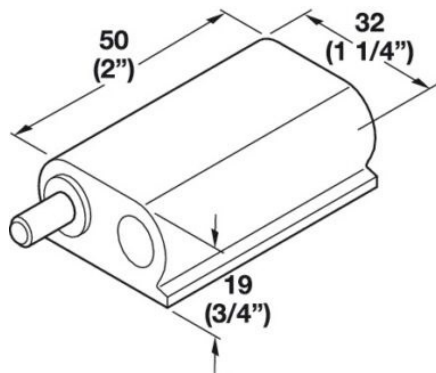
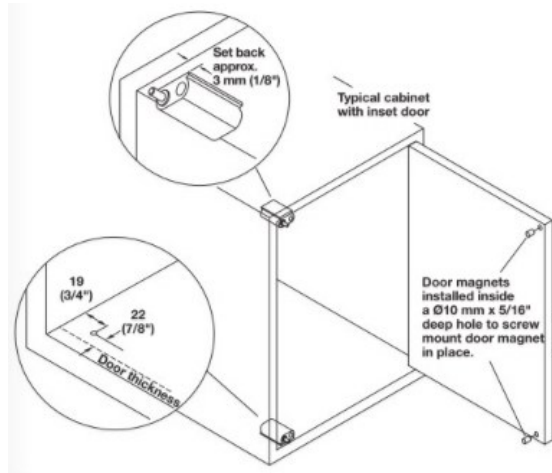

Magnetic Catch 6Kg

(Polished Chrome, Satin Chrome, Ant. Brass, Pol. Brass, Black)

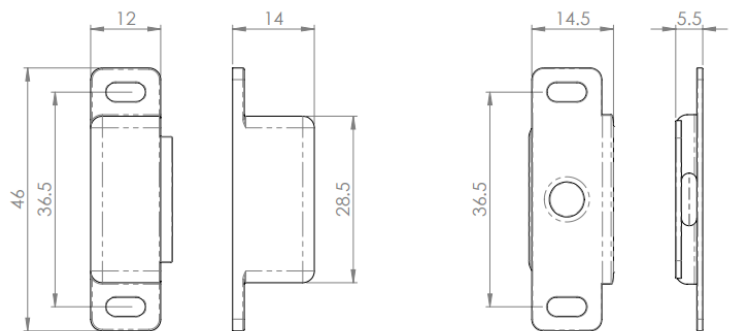

Butt Hinges 2" & 2.5" (Various colours available)



Concealed Style Hinge (full range available)



Oak Dovetail Drawers (Standard & Bespoke sizes available)



All drawers are manufactured from solid wood, and are constructed to a standard 13 or 15mm finish with a 10mm Oak veneered base. The drawers are finished with a clear lacquer and are drilled & notched to suit your

specified runner :- Blum, Hettich or Grass

Approx. lead time - 2 weeks

Oak : Walnut : Beech : Ash : Birch Ply

Pre Assembled Hettich Metal Drawers (Standard & Bespoke sizes)



Here at SCF we offer high quality Pre-Assembled drawer boxes. Assembled 'in house' we are able to create a drawer in a precision production process with a short lead time. The preassembled drawers are immediately ready for installing in the workshop or on the construction site.

Bases and rear panels matching the colour of the drawer side profile provide a consistent design thread throughout.



SCF Hardware Limited was established in 1989 and has since flourished into a premier supplier of furniture fittings, fixings and hardware.

All our furniture fittings are designed to enhance both production run and bespoke furniture. Although we can only show a limited amount of the full range of pieces available, we are continually updating and sourcing new high quality furniture hardware from home and abroad.

Browse our website to find an extensive range of cabinet hardware, bedroom and kitchen fittings, including Rubio Monocoat, furniture mouldings, turned table legs and soft close fittings.



**SCF Hardware Limited,
Unit 1 Brook Road,
Wimborne,
Dorset
BH21 2BH**

Tel: 01202 857 140

Fax: 01202 884 419

Email: sales@scfhardware.co.uk



